

SERIES 111

WIRELESS DIGITAL CALIPER

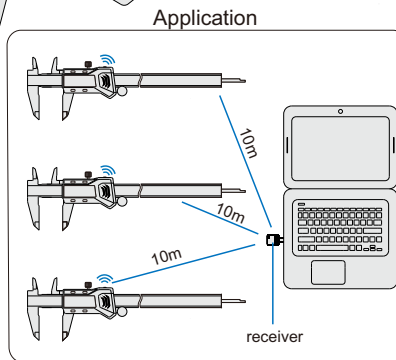

- ◆ Non waterproof
- ◆ Built-in wireless data transmission module, Zigbee signal
- ◆ Transmission distance is 10 meter (under the condition of no obstruction and no electromagnetic interference)
- ◆ Resolution: 0.01mm/0.0005"
- ◆ Buttons: on/off, zero, mm/in, INC
- ◆ Automatic power on/off
- ◆ Made of stainless steel
- ◆ Optional accessory: receiver (code 800-01 or 800-02)

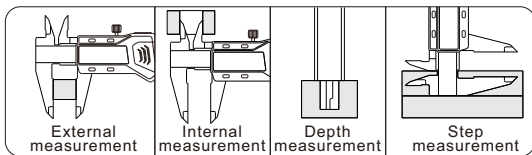
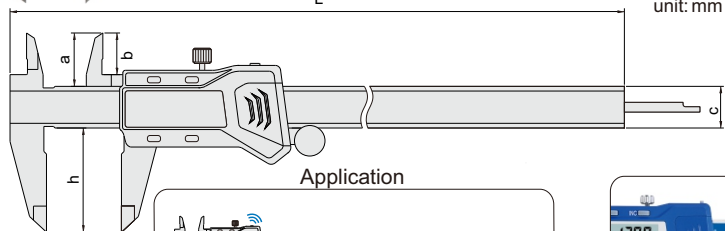
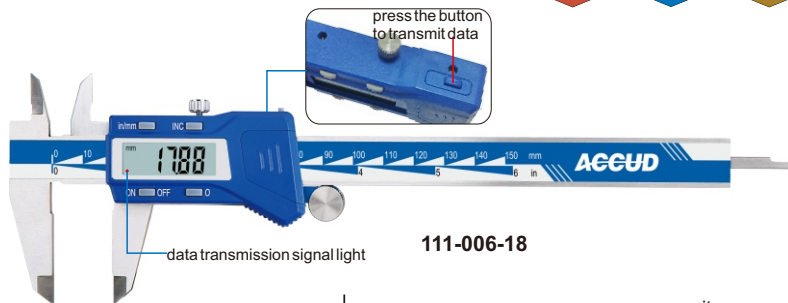

receiver (optional)



Code	Range	Accuracy	a	b	c	h	L
111-006-18	0-150mm/0-6"	±0.03mm	21	16	16	40	236
111-008-18	0-200mm/0-8"	±0.03mm	24	19	16	50	286
111-012-18	0-300mm/0-12"	±0.03mm	25	20.5	16	60	400
111-006-18W	0-150mm/0-6"	±0.03mm	21	16	16	40	236
111-008-18W	0-200mm/0-8"	±0.03mm	24	19	16	50	286
111-012-18W	0-300mm/0-12"	±0.03mm	25	20.5	16	60	400