

unit: mm

- ◆ To test crankshaft deflection
- ◆ The balance block is mounted on the back of dial indicator to keep the dial indicator facing up

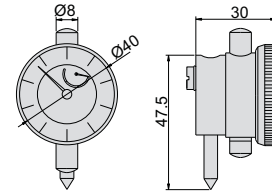

dial indicator

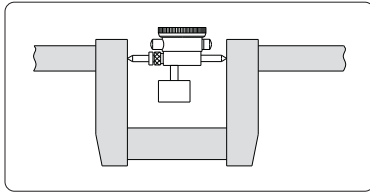
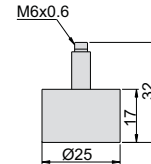

balance block

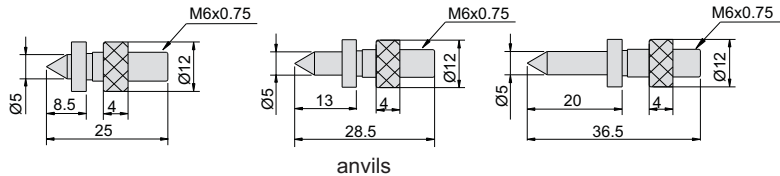

anvils

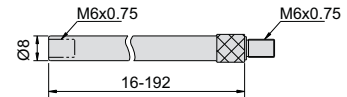

extension rods

298-012-11

| Code | Range | Dial indicator range | Graduation | Accuracy | Extension rods |
|-------------------|----------|----------------------|------------|----------|--------------------------------------|
| 298-012-11 | 60-300mm | 3mm | 0.01mm | ±0.016mm | 16mm, 32mm, 64mm, 128mm |
| 298-020-11 | 60-500mm | 3mm | 0.01mm | ±0.016mm | 16mm, 32mm, 64mm, 96mm, 128mm, 192mm |