

SERIES 630

V-BLOCK SETS

- ◆ For positioning cylindrical workpieces
- ◆ Two V-blocks per set
- ◆ Each V-block has four 90° V-grooves
- ◆ Hardness HB 170-241

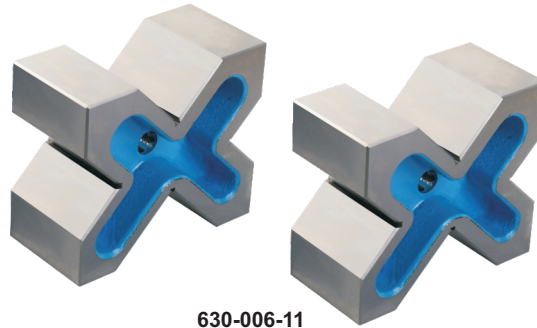

630-006-11

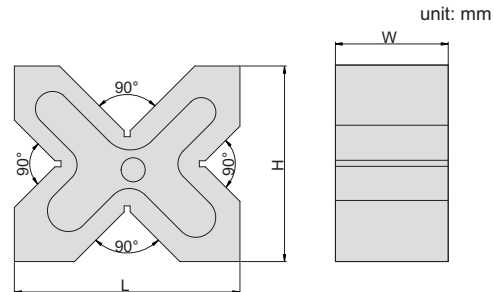
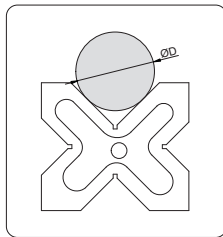

Code	Size(LxHxW)	Range of shafts(Ød)	Parallelism of four grooves to all sides	Height difference of a matched pair
630-006-11	150×130×75mm	8-120mm	15µm	20µm
630-008-11	200×170×90mm	12-180mm	15µm	20µm