

# Hydraulic Machine Vise



## Build Out Type



### Features

- Rigid material-vise body of ductile iron FCD 60JIS (equal to GGG 60) with 60 kgs/mm<sup>2</sup> or 80,000 psi tensile strength.
- Vise bed flame hardened to HRC 45 and up, takes up wear and maintain accuracy for long.
- For multiple use plural vises are available on tolerance of 0.01mm in the height of vise bed and in alignment of the clamping surface of the vise jaw at extra cost.
- Mechanical/hydraulic spindle without original clutch mechanism.
- Down thrust "Semi-sphere Segment" mechanism-eliminates jaw lifting and work flitting.
- All surface ground.

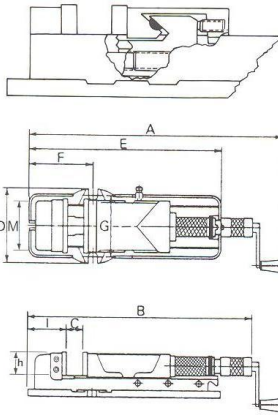

Unit:mm

ORDER NO.	A	B	C OPEN	D	E	F	G	I	M	h	CLAMPING FORCE	N.W. kgs	CODE NO.
VHO-5	695 920	570 795	0-220	190	505	180	160	105	130	55	3500kg	36.5	1002-220
VHO-6	750 1060	625 935	0-300	240	625	208	196	125	160	58	4000kg	59.1	1002-221
VHO-8	830 1140	725 1035	0-310	280	700	265	240	165	200	63	6000kg	94.3	1002-228

### Swivel Base Optional

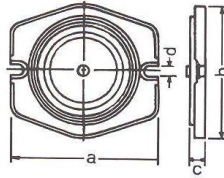

ORDER NO.	A	B	C	D	N.W. kgs	CODE NO.
HSO-5	285	263	35	16	12.5	1002-222
HSO-6	330	320	40	18	16.5	1002-223
HSO-8	415	413	50	21	35	1002-229